

10P
4013

Suzuki Grand Vitara

Modell 2006, 2008 & 2012

EU-Personenschutzbügel 60 mm hoch mit integriertem Querrohr 42 mm
EU-pedestrian protection bar 60 mm high with cross pipe 42 mm
Protection avant haut, homologuée CEE, 60 mm, traverse 42 mm



ASSEMBLY INSTRUCTION

Montageanleitung • Instructions de montage

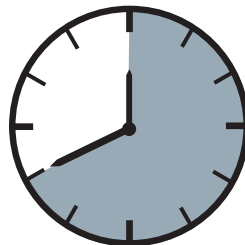

40 Minuten

Artikel-Nr:
10P4013 Stainless Steel
10P5013 Steel black

Revision 8: 05.05.2015

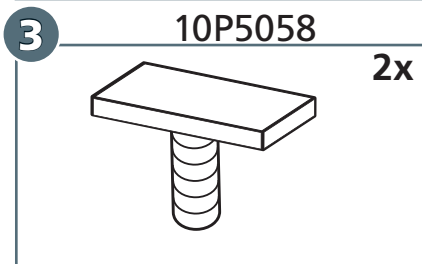
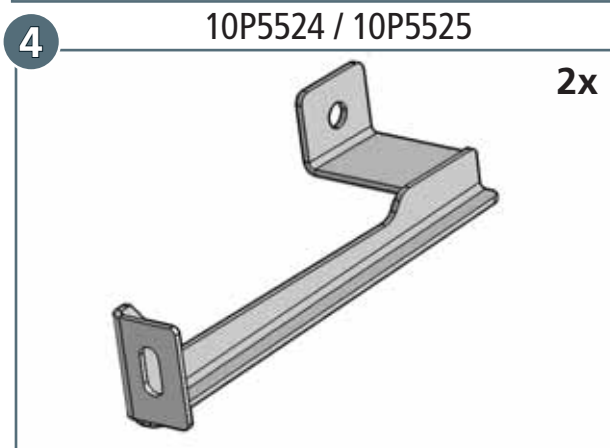
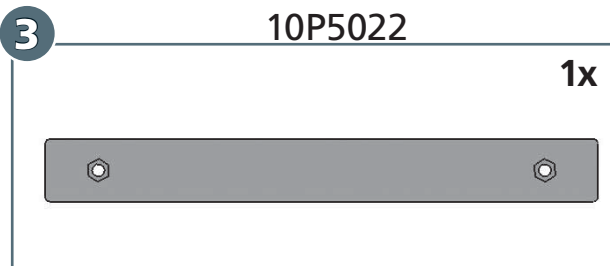
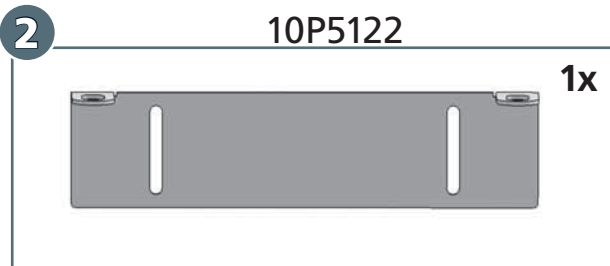
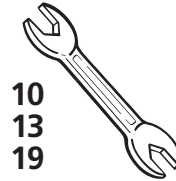
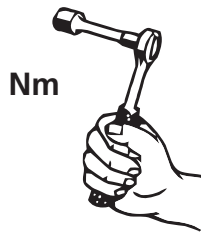

www.antec-online.de



a		M6 x 30; DIN 933 Zn	2x
b		M8 x 20; DIN 933 A2	2x
c		M12 x 25; DIN 933 Zn	2x
d		M12 (selbstsichernd); DIN 985 Zn	2x
e		Ø 6,4; DIN 9021 Zn	2x
f		Ø 8,4; DIN 9021 A2	2x
g		Ø 13; DIN 125 Zn	2x
h		Ø 13; DIN 9021 Zn	2x
i		Ø 6; DIN 127 Zn	2x
j		Ø 8; DIN 127 A2	2x
k		Ø 12; DIN 127 A2	2x
l		SW 13	2x
m		Ø 9/Ø15; Inden Nr 34986	2x

Bestell-Nr.:
 Lampenhalter-Set Ø 42
 005955
 (für 10P4013.1 / 10P5013.1)

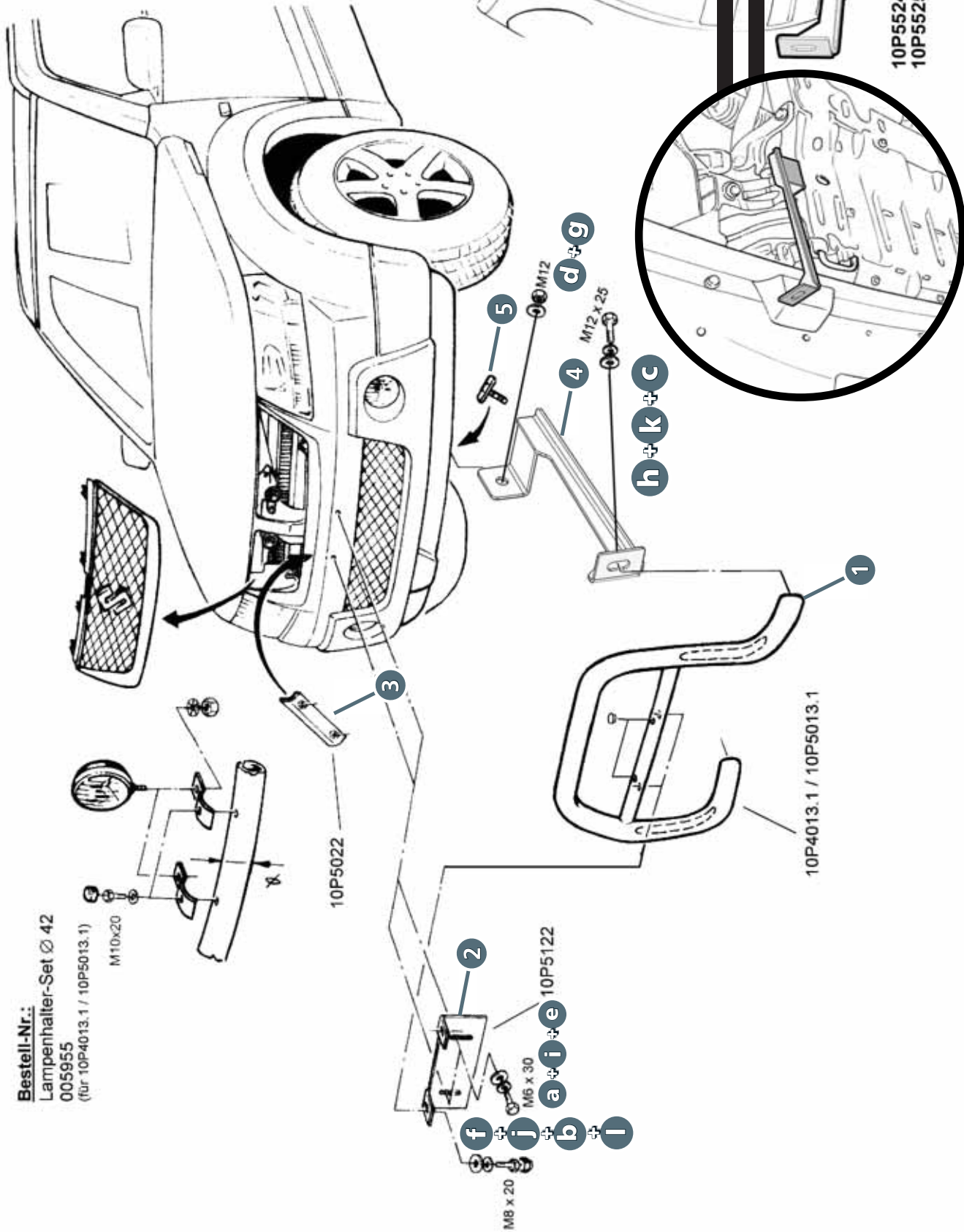
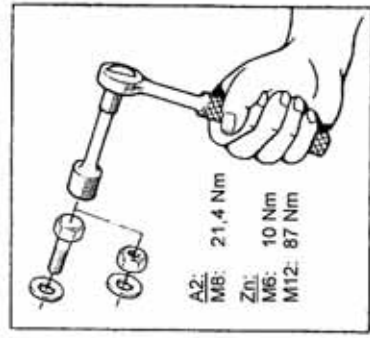
M10x20



Revision 8: 05.05.2015



ANTEC Fahrzeugtechnik GmbH
 Hubertusstr. 2, D-32256
 Fürstentfeldbrück
 Tel. +49 (0 8141) - 2 27 35 0
 Fax. +49 (0 8141) - 2 27 35 149

MONTAGEANLEITUNG

Suzuki Grand Vitara
 Modell 2006
 Modell 11/2008
 Modell 12/2012

EU-Personenschutzbügel 60
 Montagesatz

Edelstahl poliert / Stahl schwarz