

Schublade 1330 / Montagesatz mit 11E9290
Drawer 1330 / Assembly-kit with 11E9290
Tiroir 1330 / Assemble-kit avec 11E9290

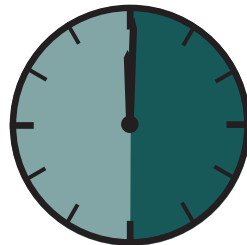

ASSEMBLY INSTRUCTION

Montageanleitung • Instructions de montage



90 Minuten

article-no:
006084 black Steel

Revision 7: 18.03.2019



Schublade 1330 / Montagesatz mit 11E9290

Drawer 1330 / Assembly-kit with 11E9290

Tiroir 1330 / Assemble-kit avec 11E9290



Required tools / Benötigte Werkzeuge / Outils requis

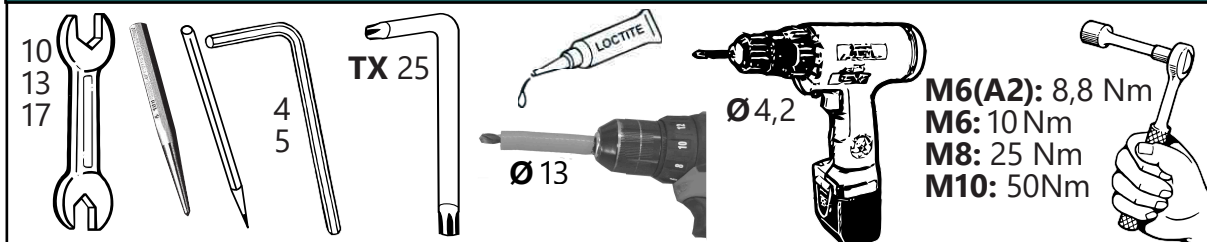

M6(A2): 8,8 Nm
M6: 10 Nm
M8: 25 Nm
M10: 50Nm

Parts list/Teileliste/Lista de accesorios

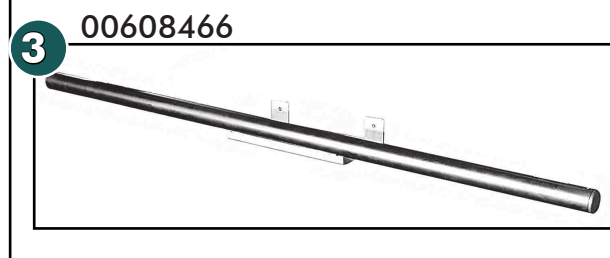
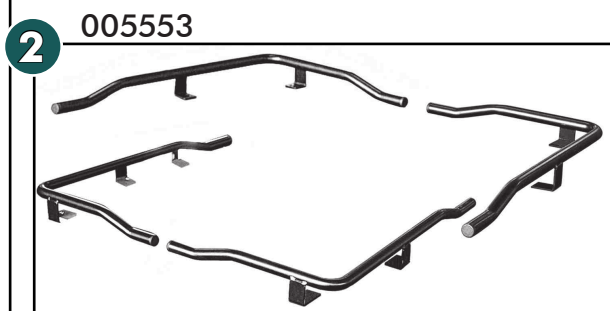
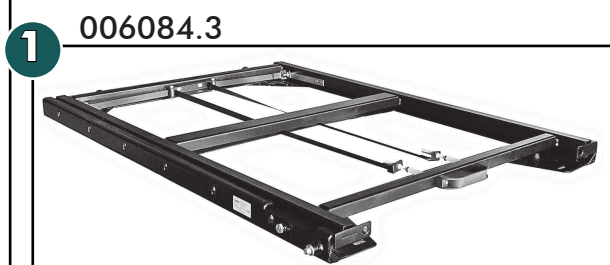

a		ø5,5x25; DIN 7976	2x
b		M6x30; DIN 7991	8x
c		M6x12; ~ISO7380	6x
d		M6x25; ~ISO7380	8x
e		M6x20; DIN 933	2x
f		M8x20; DIN 933	2x
g		M6 weld nut/Anschweißmutter/ soudure écrou	6x
i		ø6,4; DIN 9021	6x
m		M6; DIN 985 Zn	2x
n		M6; DIN 934 Zn	8x

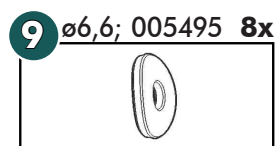
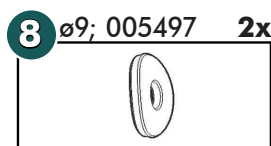

Assembly-kit / Montagesatz / Assemble-kit

11E9290

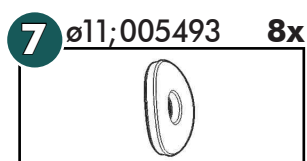
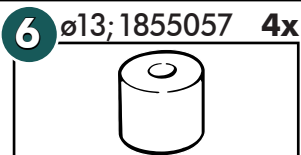
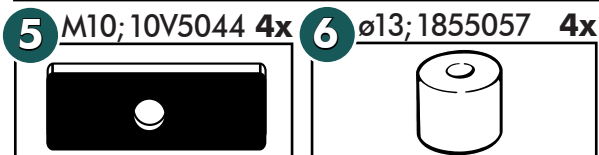

o		M10x60; DIN 933	4x
p		M10; DIN 934	4x

article-no:
006084 black Steel

Revision 7: 18.03.2019



Schublade 1330 / Montagesatz mit 11E9290
Drawer 1330 / Assembly-kit with 11E9290
Tiroir 1330 / Assemble-kit avec 11E9290

4

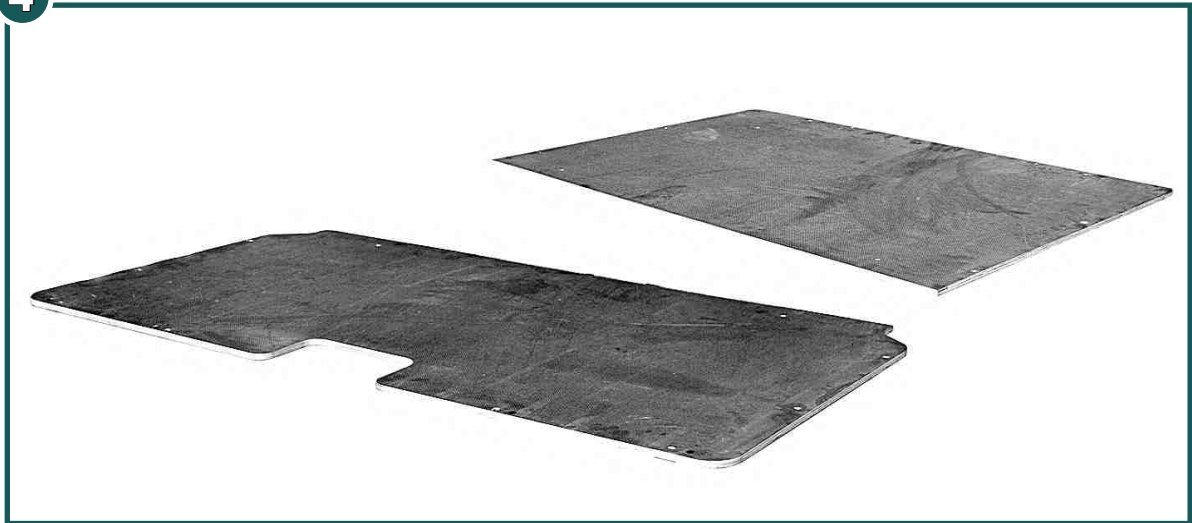

Artikel-Nr. Item-Nr. numéro d'article	KFZ Hersteller auto- motive manufacturer constructeur automobile	Bezeichnung designation désignation	Modell model modèle	Holzauflagen timber vehicle part exigences bois	A	B
11E5790N	Toyota	Hilux Double Cab	11/2006 =>	005563N	110	212

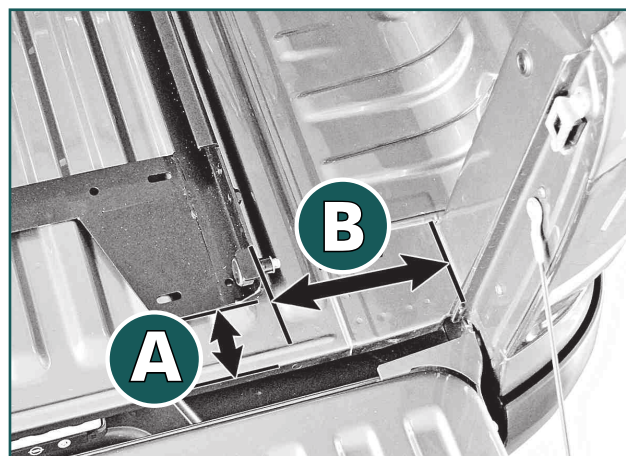

article-no:
006084 black Steel

Revision 7: 18.03.2019



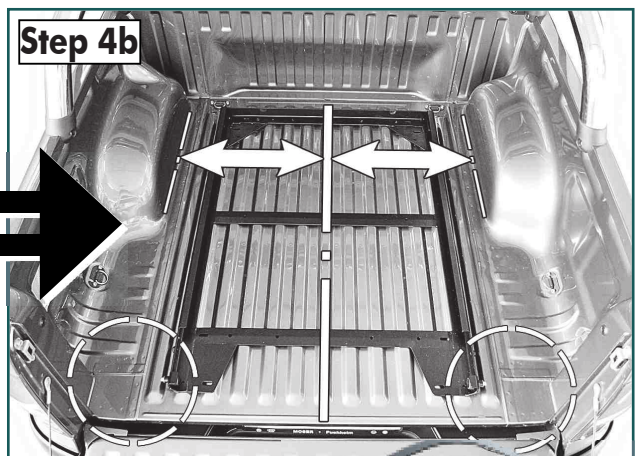
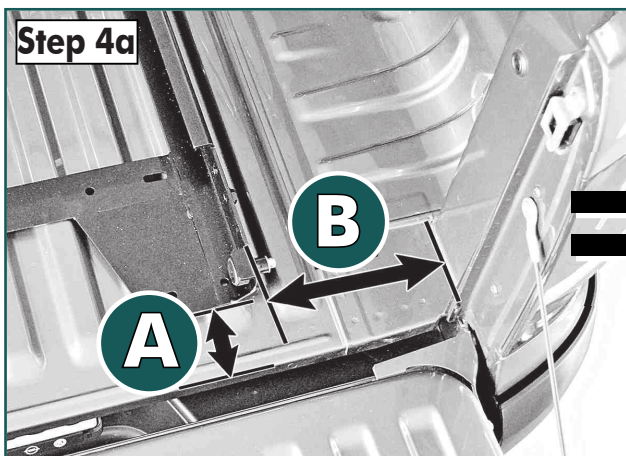
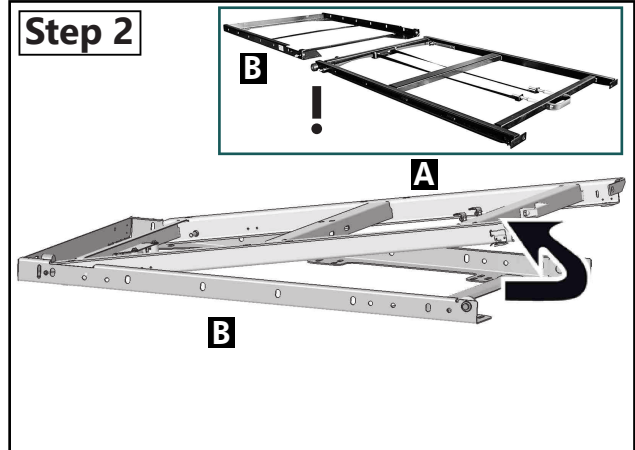
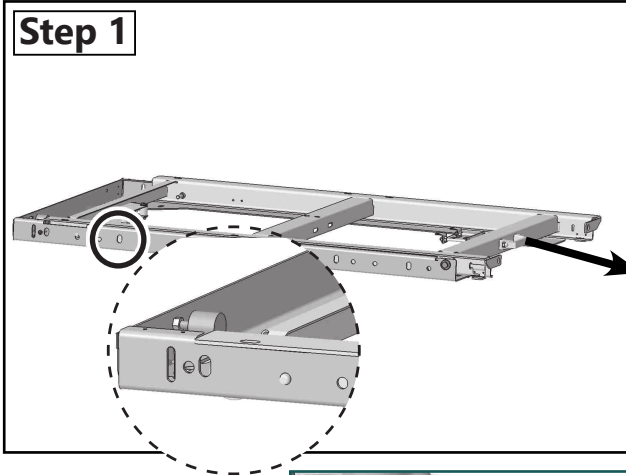
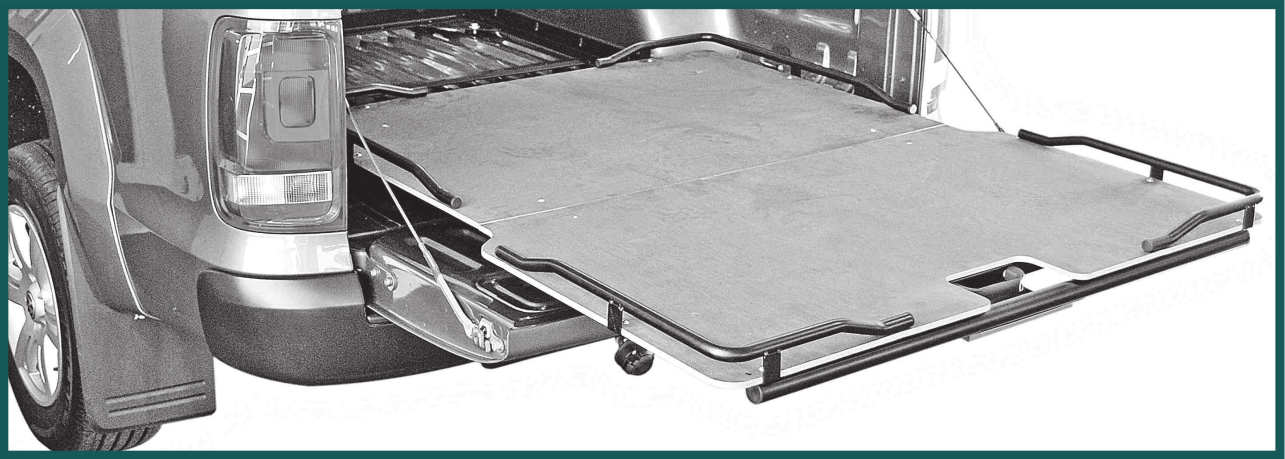

article-no:
006084 black Steel

Revision 7: 18.03.2019



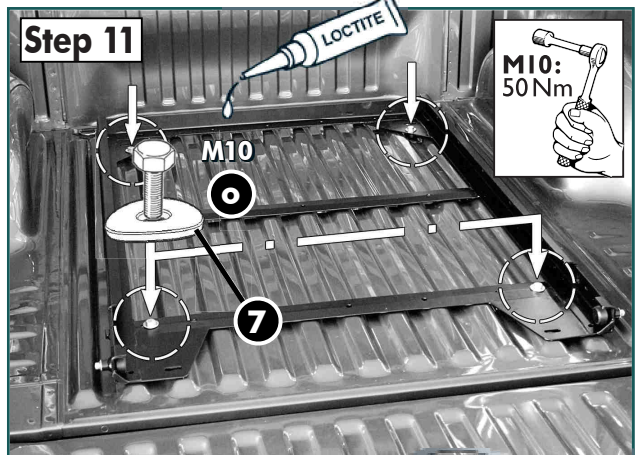
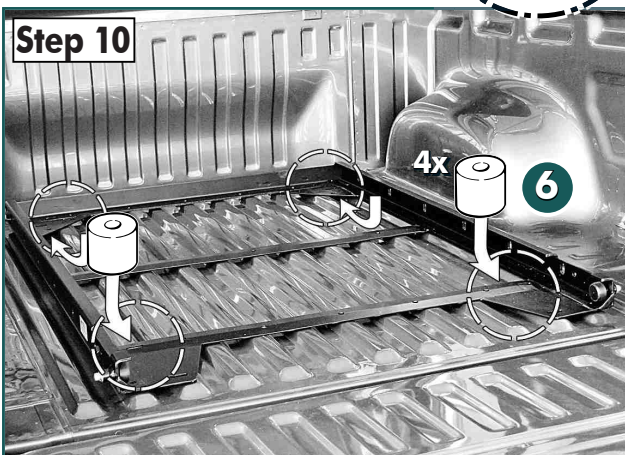
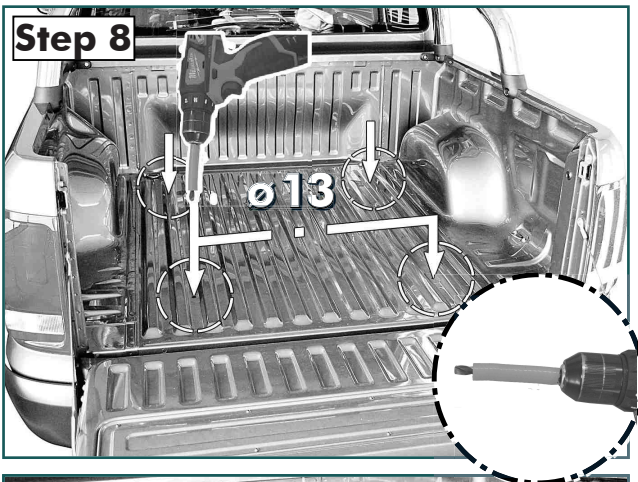
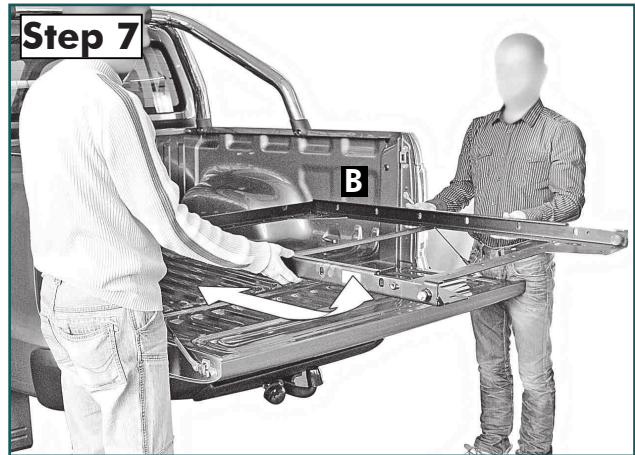
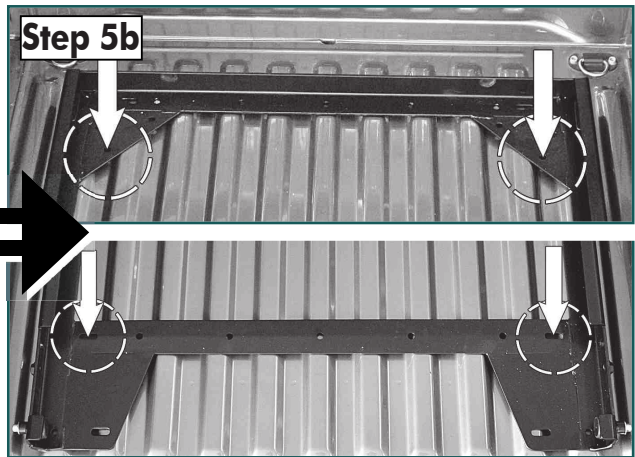

article-no:
006084 black Steel

Revision 7: 18.03.2019



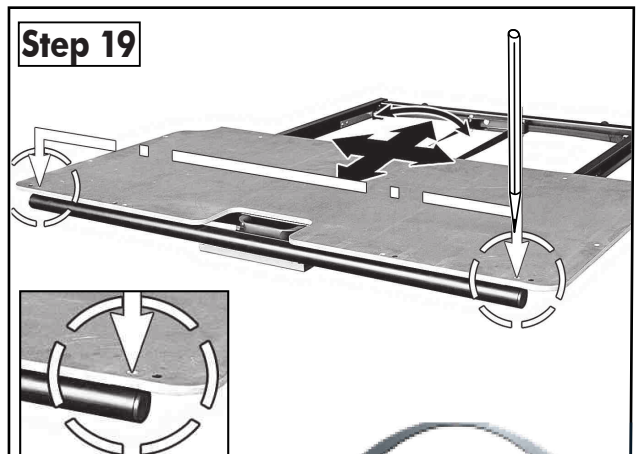
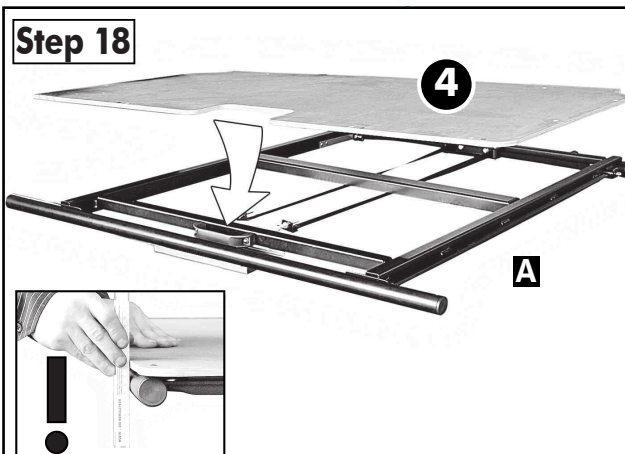
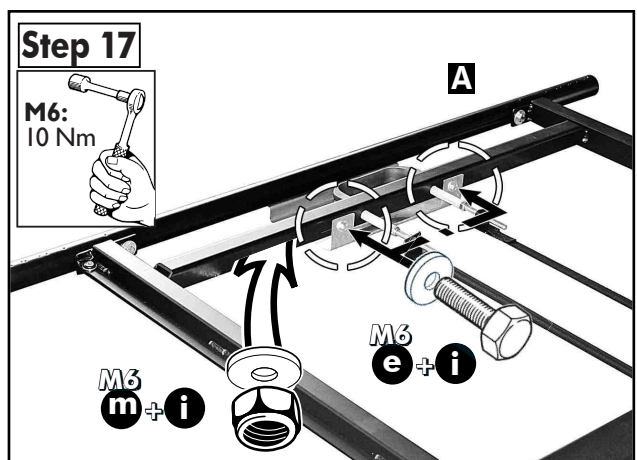
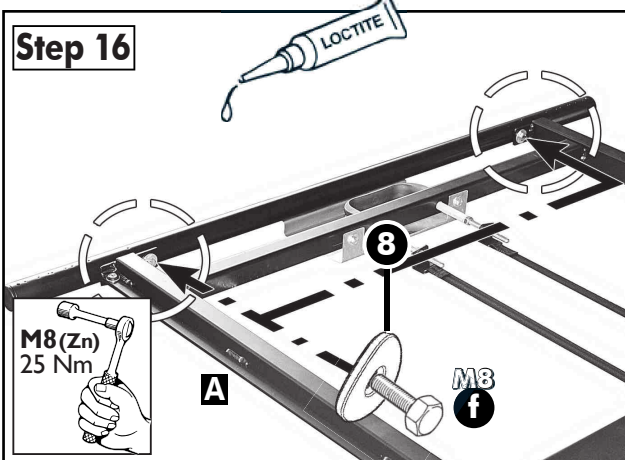
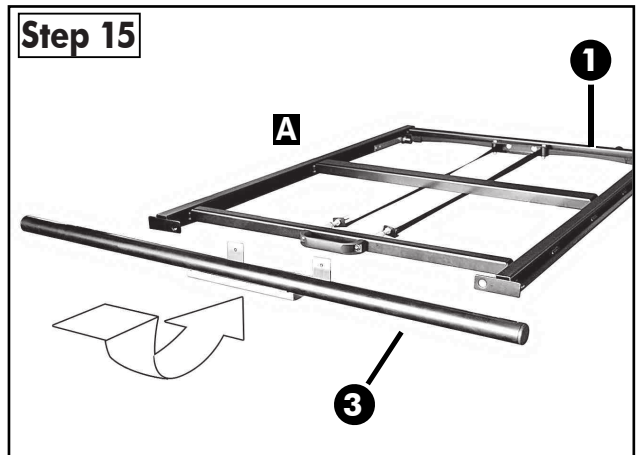
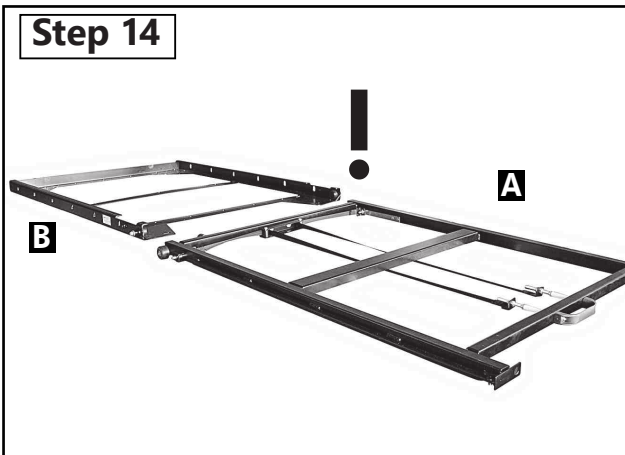
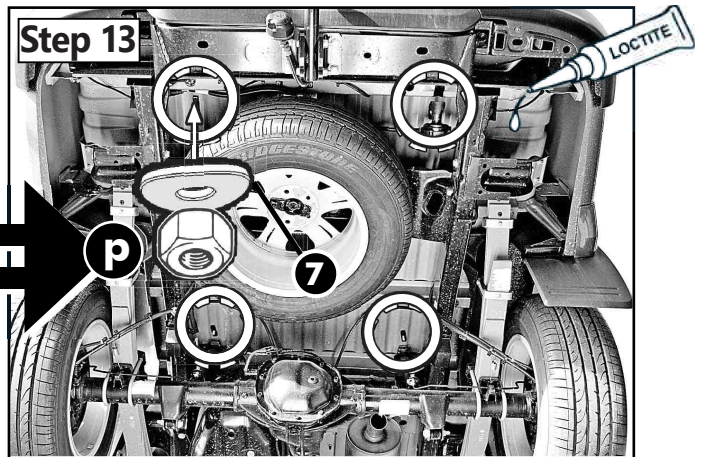
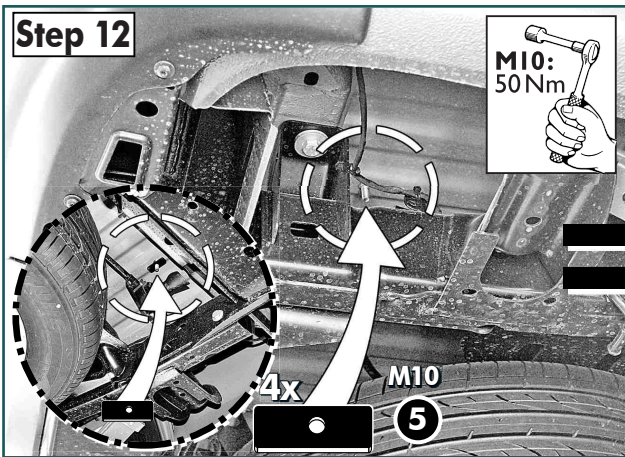

article-no:
006084 black Steel

Revision 7: 18.03.2019



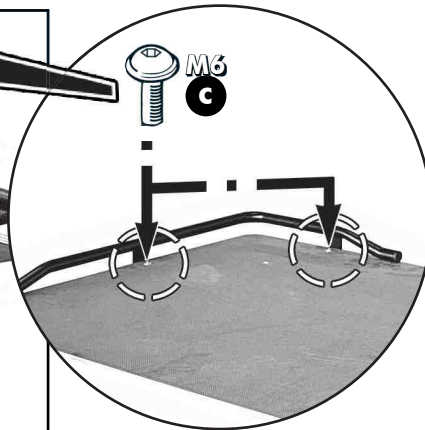
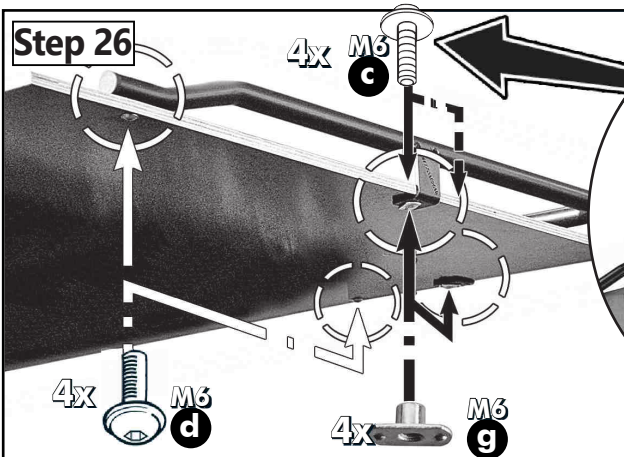
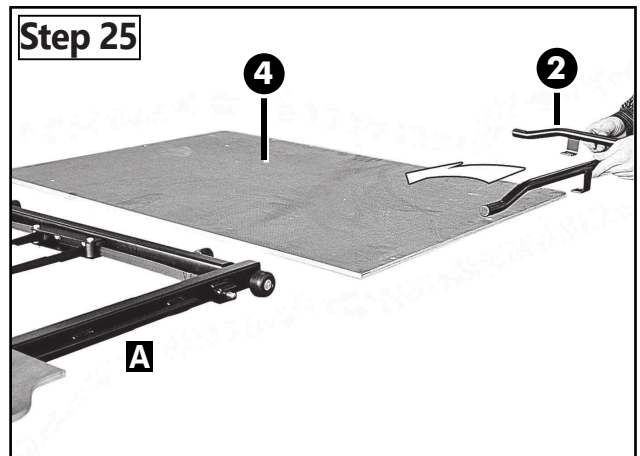
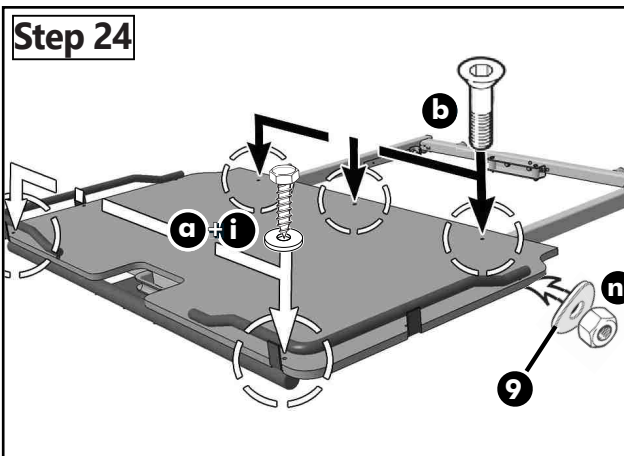
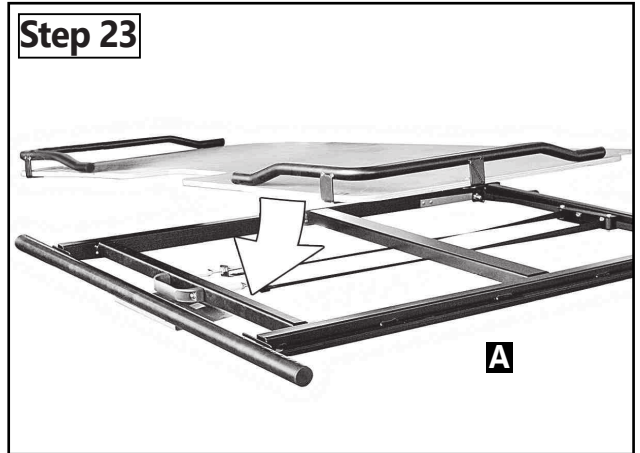
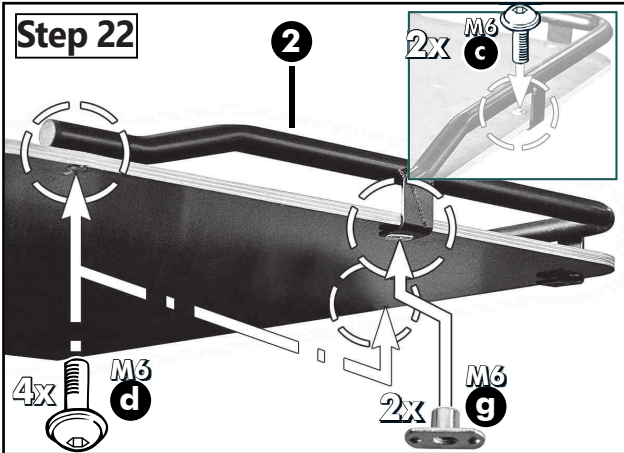
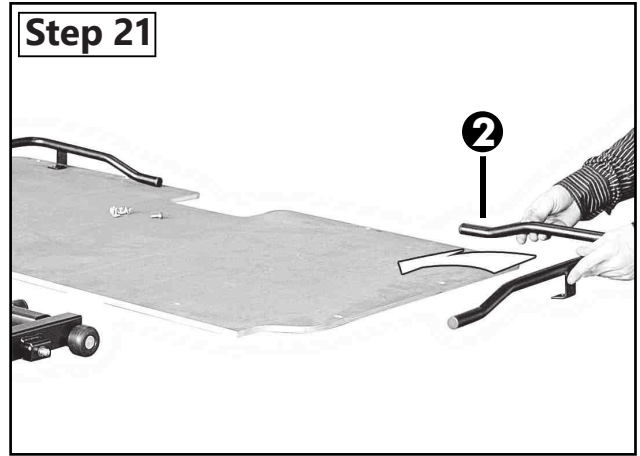
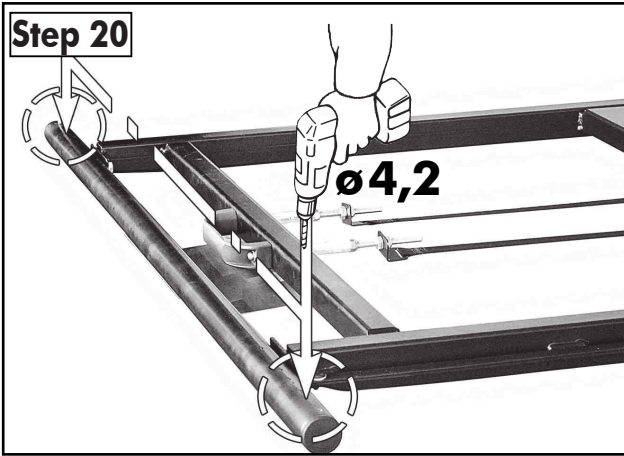

article-no:
006084 black Steel

Revision 7: 18.03.2019

- 7 -



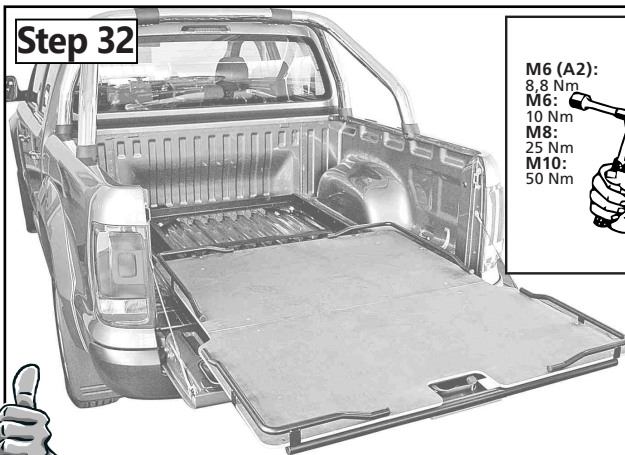
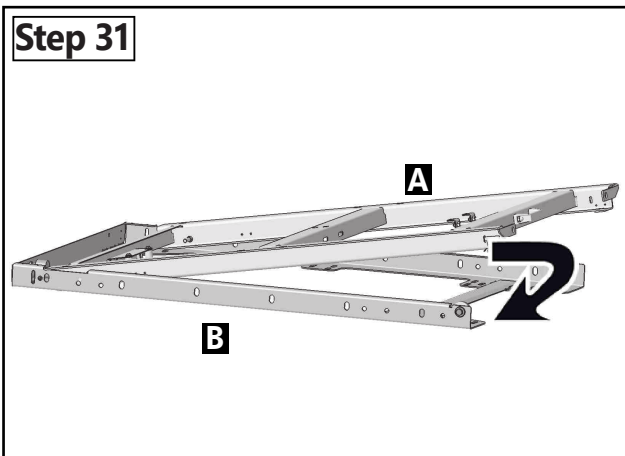
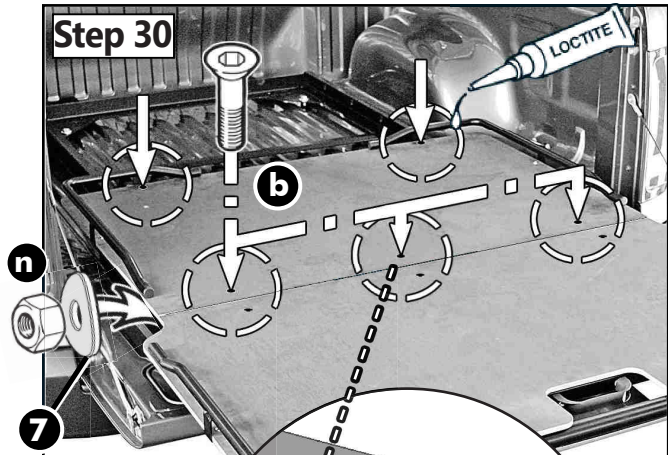
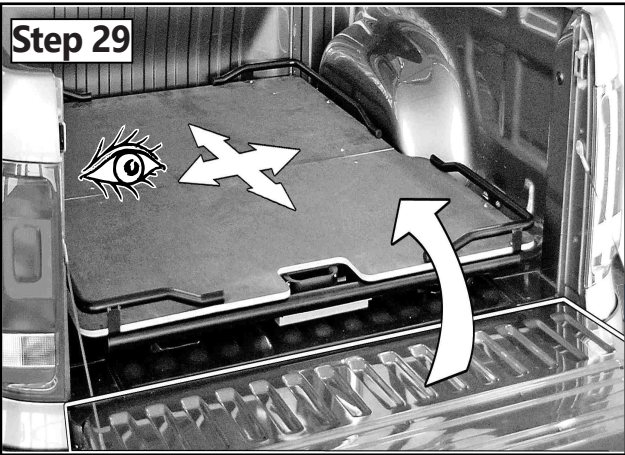
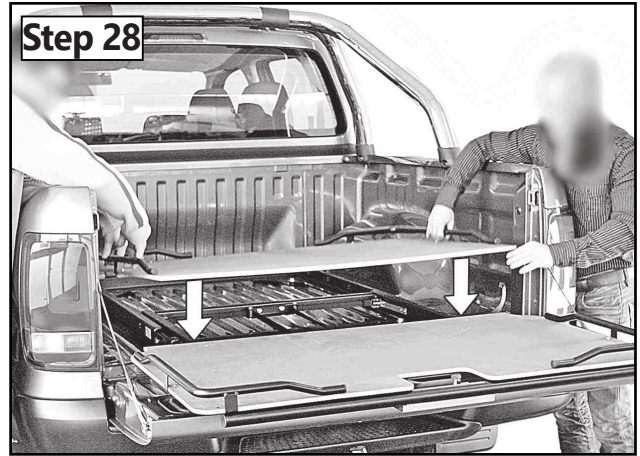
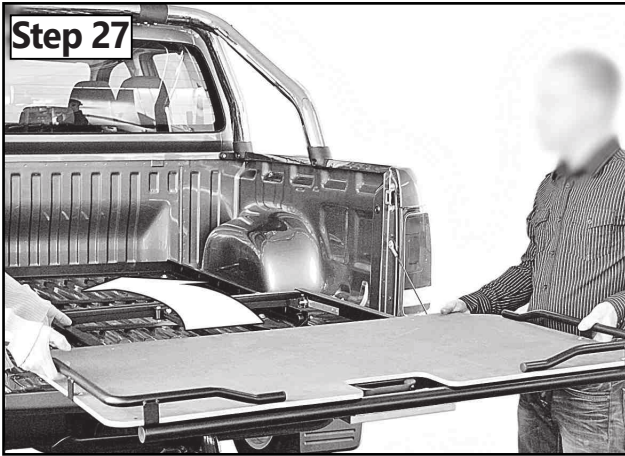

- M6 (A2): 8,8 Nm
 - M6: 10 Nm
 - M8: 25 Nm
 - M10: 50 Nm
-

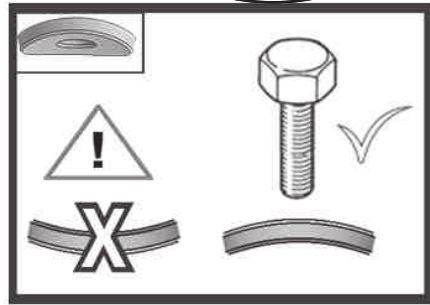

350 kg max



article-no:
006084 black Steel

Revision 7: 18.03.2019

